

Unclip the carabiner holding the two loops at the end of the strap. If the Load Release Strap is tied correctly, the carabiner should not be under load. Pull out the loop of web and without letting go of the strap, slowly remove the wraps. When the strap starts to slip, control the movement so that the load is gently transferred to the descender.

CARRYING, MAINTENANCE & STORAGE

During all use, carrying, storage, and transport keep the equipment away from acids, alkalis, exhaust emissions, rust and strong chemicals. Do not expose the equipment to direct heat, flame, or high temperatures or other adverse environmental conditions. If the equipment becomes soiled, it can be washed in cold water with a mild detergent that is safe for use with nylon and polyester. Rinse thoroughly. Do not use a pressure washer. Air dry in temperatures between 10° C and 30° C. Do not dry the equipment in direct sunlight or using an automatic dryer. Lubricate moving parts as needed. During storage and transport, protect the equipment from heat, direct sunlight, moisture, chemicals, and external loads or impacts. Do not store where the equipment may be exposed to moist air, particularly where dissimilar metals are stored together. Consult with the manufacturer in case of any doubt.

WARRANTY & REPAIRS

If your CMC product has a defect due to workmanship or materials, please contact CMC Customer Support at info@cmcprou.com for warranty information and service. CMC's warranty does not cover damages caused by improper care, improper use, alterations and modifications, accidental damage or the natural breakdown of material over extended use and time. All repair work shall be performed by the manufacturer. All other work or modifications void the warranty and releases CMC from all liability and responsibility as the manufacturer.

SAMPLE INSPECTION AND MAINTENANCE LOG

The following sample log provides an example of the records that should be maintained by the purchaser or user of life safety equipment.

EQUIPMENT INSPECTION AND MAINTENANCE LOG			
Item _____ # _____		Date in Service _____	
Brand/Model _____		Strength _____	
Date	How Used or Maintained	Comments	Name

 Find the latest version of this manual at cmcprou.com.



CMC Rescue, Inc.
6740 Cortona Drive
Goleta, CA 93117, USA
805-562-9120 / 800-235-5741
cmcprou.com

ISO 9001 Certified

© CMC Rescue, Inc. All rights reserved

CMC and  are registered marks of CMC Rescue Inc.

CMC Control No.: 201108-01IN01_Rev00

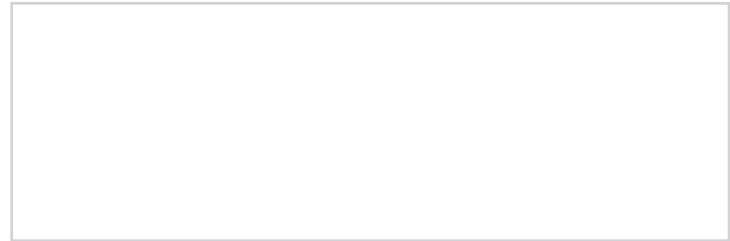

LOAD RELEASE STRAP

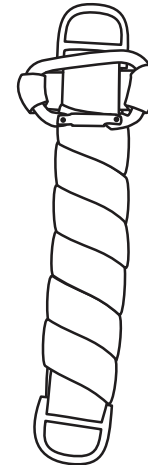

⚠ WARNINGS

Activities involving the use of this device are potentially dangerous. You are responsible for your own actions and decisions. Before using this device, you must:

- Read and understand these user instructions, labels, and warnings.
- Familiarize yourself with its capabilities and limitations.
- Obtain specific training in its proper use.
- Understand and accept the risks involved.

FAILURE TO HEED ANY OF THESE WARNINGS MAY RESULT IN SEVERE INJURY OR DEATH.



MEETS THE END-TO-END STRAP REQUIREMENTS OF NFPA 1983, INCORPORATED IN THE 2022 EDITION OF NFPA 2500.

- 201108-01 CMC LOAD RELEASE STRAP, RATED FOR GENERAL USE (G) MBS 29 KN (6,519 LBF)

Load Release Strap Set Up

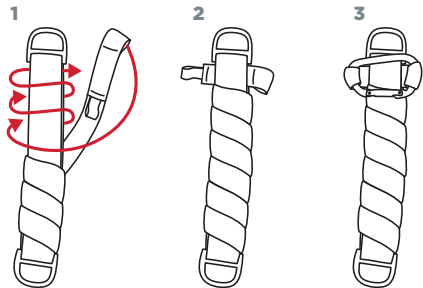

USER INFORMATION

User Information shall be provided to the user of the product. NFPA Standard 1983, incorporated into the 2022 edition of NFPA 2500 recommends separating the User Information from the equipment and retaining the information in a permanent record. The standard also recommends making a copy of the User Information to keep with the equipment and that the information should be referred to before and after each use.

Additional information regarding life safety equipment can be found in NFPA 1500 and NFPA 1858 and NFPA 1983, incorporated in the 2022 edition of NFPA 2500.

LIFESPAN / INSPECTION / RETIREMENT

The equipment has a lifespan of 10 years from the date of manufacture shown on the product label. The type of use, intensity of use, and environment of use are all factors in determining serviceability of the equipment. A single exceptional event can be cause for retirement after only one use, such as exposure to sharp edges, extreme temperatures, chemicals, or harsh environments. Any concerns about its safe use is cause for retirement. Remove retired equipment from service and destroy it to prevent further use.

A device must be retired when:

- It fails to pass inspection.
- It fails to function properly.
- It has illegible product labels or markings.
- It shows signs of damage or excessive wear.
- It has been subjected to shock loads, falls, or abnormal use.
- It has been exposed to harsh chemical reagents.
- It has an unknown usage history.
- You have any doubt as to its condition or reliability.
- When it becomes obsolete due to changes in legislation, standards, technique or incompatibility with other equipment.

Inspect the equipment according to your department's policy for inspecting life safety equipment. CMC recommends a detailed inspection by a competent person at least once every 12 months depending on current regulations and conditions of use. Record the date, inspector name, and inspection results in the equipment log as well as any other relevant information to track the usage history.

Before each use, the user should:

- Confirm the equipment is functioning properly.
- Verify the presence and legibility of the product labels and markings.
- Check soft components for cuts, worn or frayed areas, broken fibers, soft or hard spots, discoloration, or melted fibers. Check the stitching for pulled threads, abrasion, or breaks.
- Check hard components for excessive wear or indications of damage such as deformation, corrosion, sharp edges, cracks, or burrs. Minor nicks or sharp spots may be smoothed with emery cloth or similar.
- Check for the presence of dirt or foreign objects that can affect or prevent normal operation such as grit, sand, rocks, and debris.

During Each Use, the user should:

- Confirm all pieces of equipment are correctly positioned with respect to each other.
- Monitor the condition of the equipment and its connections to other equipment in the system.
- Do not allow anything to interfere with the operation of the equipment or its components.
- Prevent foreign objects from interfering with moving parts.

LIMITATIONS AND PROPER USE

CMC Load Release Strap is intended to be used for the same purpose as a load release hitch. It enables the load on a rope grab to be transferred to another device, usually a lowering device used as a system brake.

SET UP

Refer to the Load Release Strap Set Up diagram and follow the steps below.

1) Pull the end of the strap until the floating Wide D-Ring is close to the end of the stitched section of web. 2) Wrap the web firmly around itself several times, leaving an area to pass the loop end through the strap. 3) With a carabiner, connect the two loops together.

LOAD TRANSFER

Before releasing the Load Release Strap, be sure that the load is being transferred to a secure anchor, such as a locked-off descender or a fixed line. Always check that all carabiners, connectors and buckles are securely fastened before tension is transferred. Never expose the strap to sharp edges, fire or any situation that will cause damage to the strap while in use.